

**10, 11, and 15 Gallon 3000 psi
 Patented Float Accumulators**
 6000 psi also available. Call factory.

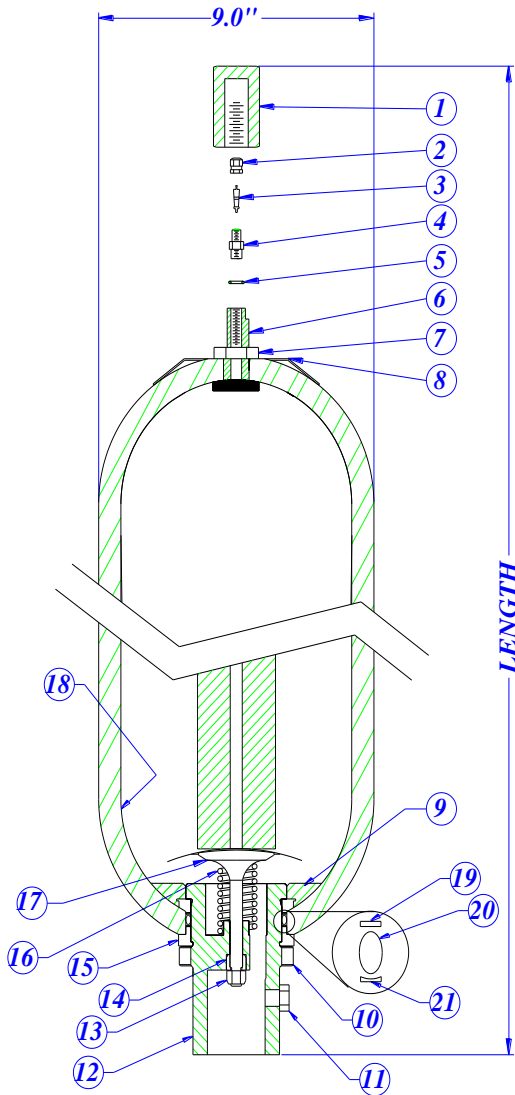

List of Component Parts		
Description	Part Number (XS)	
1	Solid Protective Cap	AI-306-4-SS
2	Valve Cap	AI-S-303
3	Valve Core	AI-S-304
4	GT Gas Valve	AI-GT3-309
5	Gas Valve O-Ring	AI-GT3-310
6	Rubber Coated Valve Stem	AI-R3-302-SS
7	Hex Jam Nut	AI-S-305
8	Name Plate	AI-S-413
9	Anti-Extrusion Ring	
	Buna-Nitrile	AI-S-407-WS
	EPDM	AI-S-407-E-WS
	Fluorocarbon	AI-S-407-V-WS
10	Locknut	AI-S-403-SS
11	Bleed Plug	
	1/4" NPT	AI-S-418-SS
	7/16"-20 SAE	AI-S-419-SS
12	Oil Port ³	AI-S3-402-SS
13	Stop Nut	AI-S-408-SS
14	Piston	AI-S-405-SS
15	Spacer	AI-S3-406-SS
16	Spring	AI-S3-409-SS
17	Poppet Assembly	AI-F-431-SS
18	Shell (3000 psi)	Not for Sale
19	Metal Back-Up Ring	AI-S-412-SS
20	O-Ring	
	Buna-Nitrile	AI-S-410
	EPDM	AI-S-410-E
	Fluorocarbon	AI-S-410-V
21	Rubber Back-Up Ring	AI-S-411

Standard Configuration

- SA-372 Chrom-moly Steel Shell
- 2 Piece Replaceable Gas Valve
- C-1018 and 4130 or 41040 parts
- 2" NPT Female Fluid Port
- Buna-Nitrile Rubber Components

Optional Configuration (at extra cost)

- AN Gas Valve
- Resin Coatings, Internal (WS)
- Electroless Nickel Plating, Internal & External (SS)
- Resin Coating – ID, 3 Part Marine Epoxy Paint – OD (XS)
- Stainless Steel Components
- Foreign and Domestic Codes
- Call Factory for Other Options

Dimensions ⁴		
Part Number	Length	Weight
A10F3100	54"	220 lbs
A11F3100	60"	232 lbs
A15F3100	78"	304 lbs

Fluid Port Options	
Fluid Port Type	Designation
2" NPT Female	None
1 1/4" NPT Female	-1
Metric Female	-2
1 1/8"-12 SAE Female	-3
Code 61, 2" SAE 61 Split Flange	-4
Other	Call
Special Materials	Call

1 OS-Oil Service, WS- Water Service, SS-Special Service
 2 Special service accumulator uses a solid protective cap
 3 See Oil Port Options for configuration options
 4 Nominal dimensions. Manufacturing variations will occur